



September Way

Stanmore

Offers in excess of £250,000

A one bedroom, purpose-built flat with a large roof terrace for recreational use available with Davidson Frost-Wellings.

The flat has a large reception room with large windows allowing for lots of natural light. There is also a separate kitchen, large bedroom with built-in wardrobes, a large bathroom and lots of built-in storage off the hallway.

Parking is available on a first-come-first-served basis.

Leasehold with 81 years remaining.

Service charge of approximately £150 per month.

Ground rent of £100 per year.

Harrow Council tax band C.

- One bedroom
- Roof terrace
- Top floor
- Separate kitchen
- Lots of storage
- Leasehold

Viewing

Please contact our Davidson Frost-Wellings Office on 020 8954 8806 if you wish to arrange a viewing appointment for this property or require further information.



Floor Plan

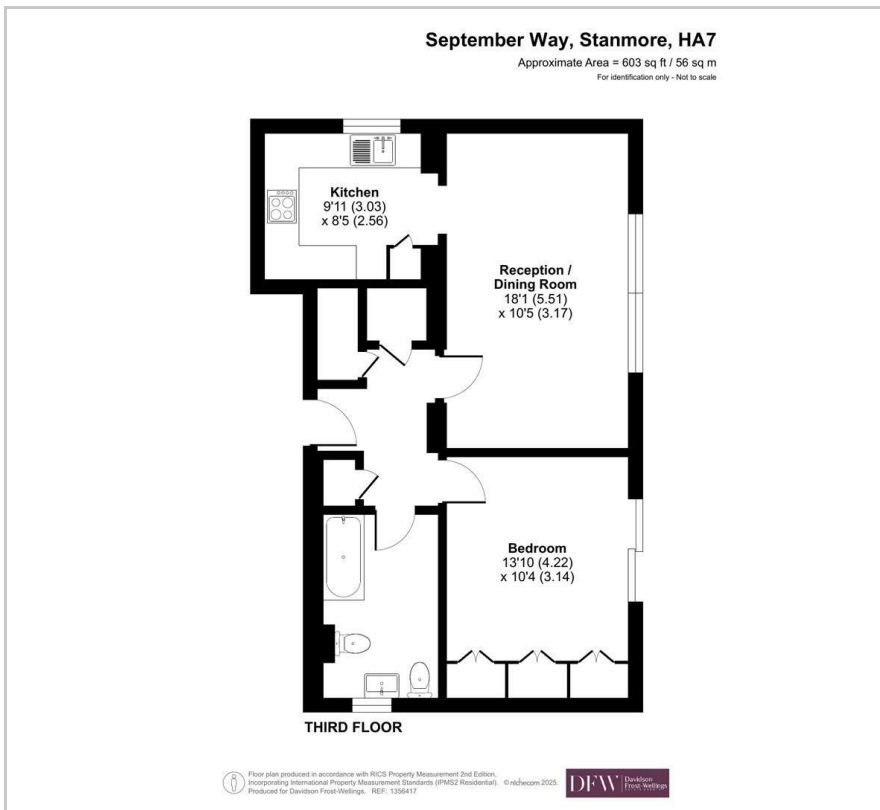

Area Map

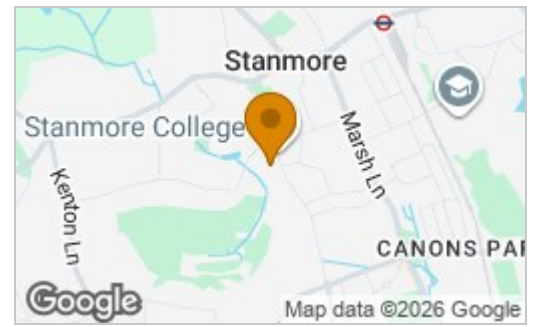

Energy Efficiency Rating

	Current	Potential
<i>Very energy efficient - lower running costs</i>		
(92 plus) A		
(81-91) B		
(69-80) C		
(55-68) D	58	72
(39-54) E		
(21-38) F		
(1-20) G		
<i>Not energy efficient - higher running costs</i>		
England & Wales	EU Directive 2002/91/EC	



These particulars, whilst believed to be accurate are set out as a general outline only for guidance and do not constitute any part of an offer or contract. Intending purchasers should not rely on them as statements of representation of fact, but must satisfy themselves by inspection or otherwise as to their accuracy. No person in this firm's employment has the authority to make or give any representation or warranty in respect of the property.